

# Create a Dynamic M365 Group

You cannot use Dynamic SG for SharePoint access for groups. In this case you need to create a M365 Dynamic Group Instead. This is useful for having an ALL users, All Staff so on, once they are onboarded.

## 1. Go to **AAD Admin Centre**

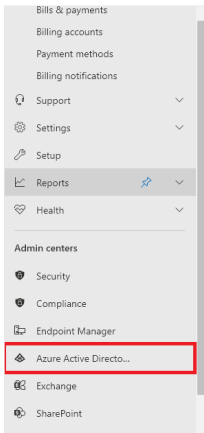

## 2. Go to **Groups > All Groups**

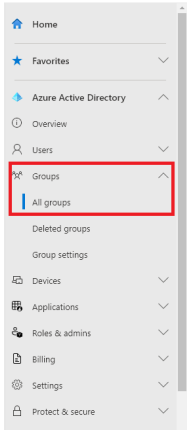

## 3. Select **New Group**

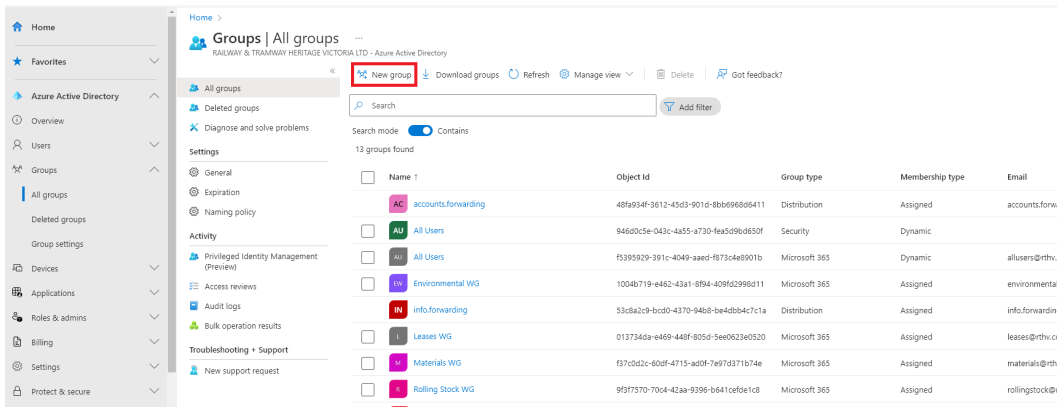

#### 4. Change group type to **Microsoft 365**

[Got feedback?](#)

Group type \* ⓘ  
Microsoft 365

Group name \* ⓘ  
Test

Group email address \* ⓘ  
Testtest @rthvictoria.onmicrosoft.com

Group description ⓘ  
Enter a description for the group

Azure AD roles can be assigned to the group ⓘ  
Yes No

Membership type \* ⓘ  
Assigned

**Use group sensitivity labels in Azure Active Directory to classify and protect Microsoft 365 groups. [Learn more](#) about assigning sensitivity labels in AAD.**

Owners  
No owners selected

Members  
No members selected

5. Fill in the details as you wish. *Don't worry that the Group Email Address may show as a .onmicrosoft.com address, it will change to the default domain through 365 eventually.*

6. Click **Create** and it will take you back to the All Groups page

7. Select your group and go to **Properties**

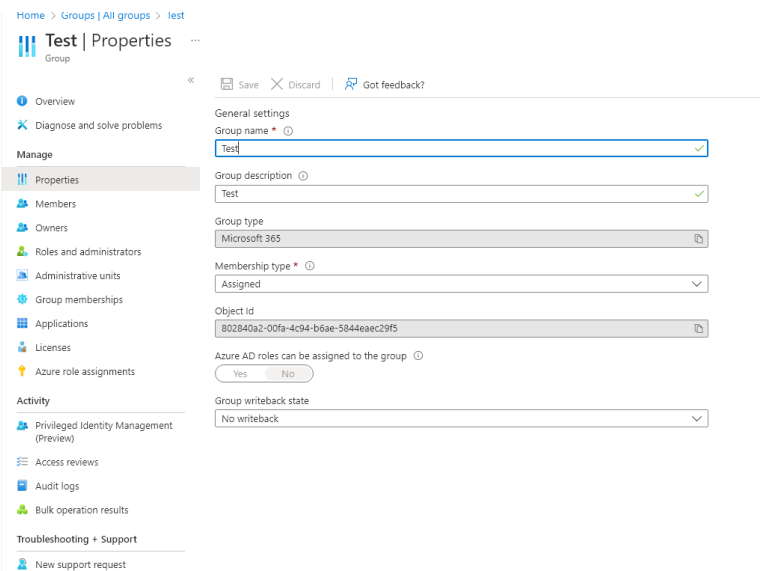

8. Membership Type to **Dynamic User** then select **Add Dynamic Query**

9. You can find a lot of information on the types of queries you will have to include here:

<https://learn.microsoft.com/en-us/azure/active-directory/enterprise-users/groups-dynamic-membership>

Common ones are:

All users- **user.objectId -ne null** this includes Users, Guest Users, Shared Mailboxes and Groups.

All users except guest users (**user.objectId -ne null**) -and (**user.userType -eq "Member"**)

---

Revision #1

Created 22 February 2023 01:50:02 by Dylan Healey

Updated 22 February 2023 02:37:34 by Dylan Healey