

Windows File Server Shares

For setting up restricted access to drives on windows file server shares please ensure that the following setting is disabled on the desired share:

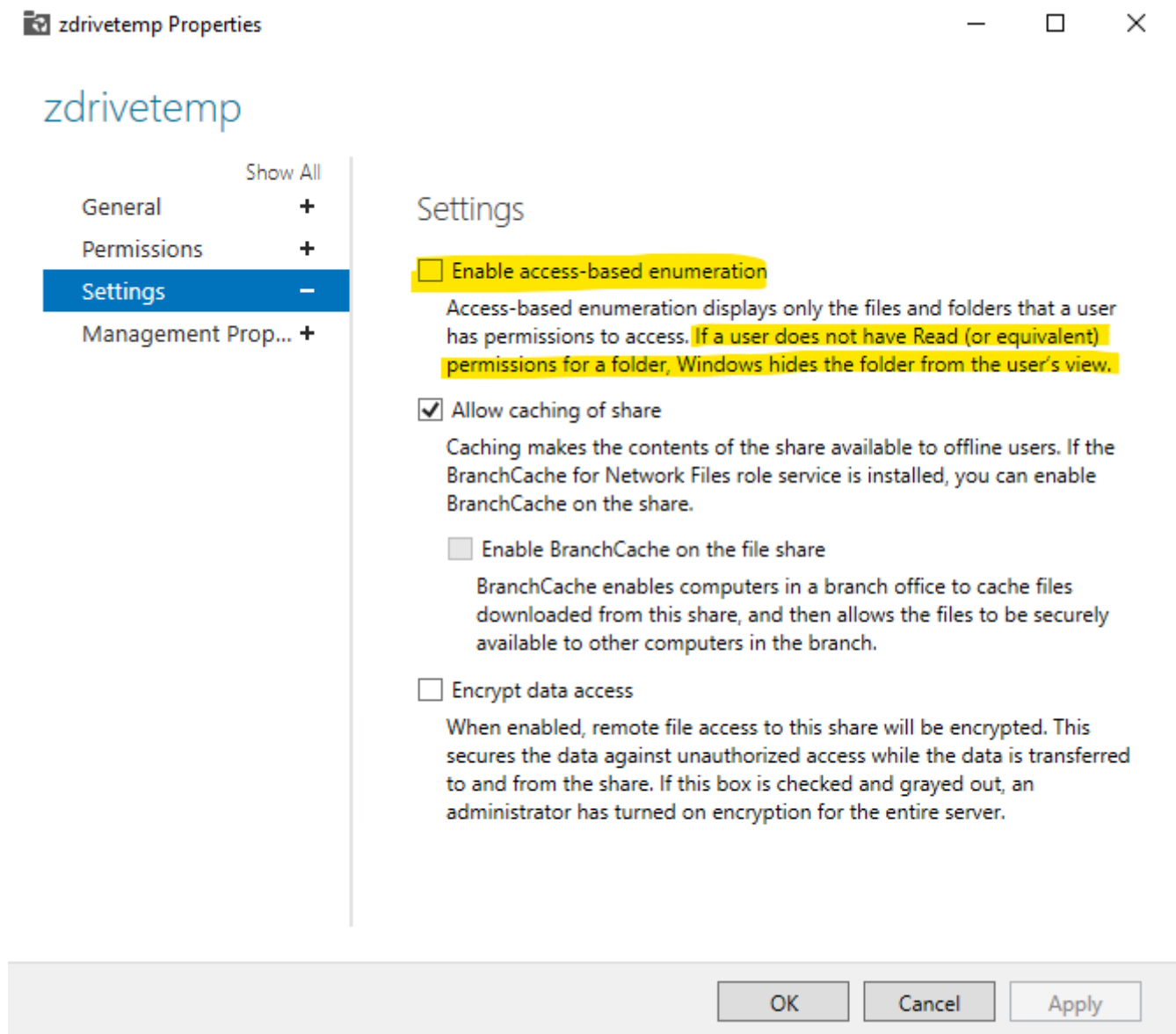

If trying to use traverse and list folder, the above setting will prevent users from viewing these shares.

For ZdriveTemp the Share has been set so the above settings has been unchecked. This is to ensure permissions on the Z drive are locked down.

